

## OWP60-1W12V

### Product Features

Ambient Temperature: (-40 to +60) °C  
Ripple:  $\leq 120\text{mV}$  (p-p)  
Certifications: CE + UL compliant  
Surge Protection: L-N 6KV · L/N-G 6KV  
Compact Size  
Waterproof Connector Supported  
Over-Temperature Protection (OTP)

### Application



LED Strip Light



### Technical Paramaters

Model	OWP60-1W12V	
Input	Voltage	UL Rated 120-277Vac, CE Rated 220-240Vac
	Frequency Range(Hz)	50/60Hz
	Efficiency	$\geq 88\%$ @120VAC, $\geq 90\%$ @277VAC, full load
	PF	$\geq 0.95$ @120V-277VAC, full load
	Current	0.72A max@120VAC, 0.28A max@277VAC, full load
	THD	$< 10\%$ @120-277VAC, full load
	Inrush current	Cold start, 18.5A@120VAC 200us, 48A@277VAC 210us,
	No load power	$< 0.5\text{W}$
	Turn on delay Time	$\leq 0.5\text{ s}$ , at120Vac (When the light begins to shine)
outputoutput	Channel	1
	Voltage	12VDC
	Output Voitage	0-5A
	Power	60W
	Current Accuracy	$\pm 3\%$
	Ripple Voitage	$\leq 120\text{mV}$ (p-p)
	No load output voltage	12.6VDC max
Protection	Over load	Hiccup Protection, Auto-recovery after Fault Clearance
	Short circuit	No Output, Auto-recovery after Fault Clearance
	Over Current	Hiccup Protection, Auto-recovery after Fault Clearance
	over temperature	Output power drops to 50% at 75-80°C ambient (Tc $\approx 95^\circ\text{C}$ -100°C ), recovering automatically when temperature normalizes.
Safety&EMC	Surge	L-N 6KV L/N-G 6KV
	Withstand Voltage	I/P-O/P:3000Vac/1min/<5mA, I/P-G:1800Vac/1min/<5mA, O/P-G:500Vac/1min/<5mA,
	Safety standards	EN61347-1 · EN61347-2-13 · UL8750 · UL1310 · UL879
	EMC Eission	EN55015, FCC Part 15 Class B
	EMC immunity	EN61000-4-2, 3, 4, 5, 6, 8, 11; EN61547
	Insulation Resisance	5M $\Omega$
Function	Dimming type	Non regulated
	Flicker	No strobe
Others	Dimension	181*40.8*30mm(L*W*H)
	Packing size	Net weight: 385g $\pm 5\%$ /PCS; 30PCS/Carton; 12.05kg $\pm 5\%$ /Carton; Carton Size: 425x185x170mm(L*W*H)
	Working temp.	ta: -40-60°C,
	tc	85°C
	Storage Temp., Humidity	-40°C -85°C, 20-90%RH
	Lifetime	50,000h@tc:85°C
	Warranty	5 years
	IP rating	IP67
	Material	Metallic/Silver
	Switch cycle	>25000 times

Dimension mm (Inch)

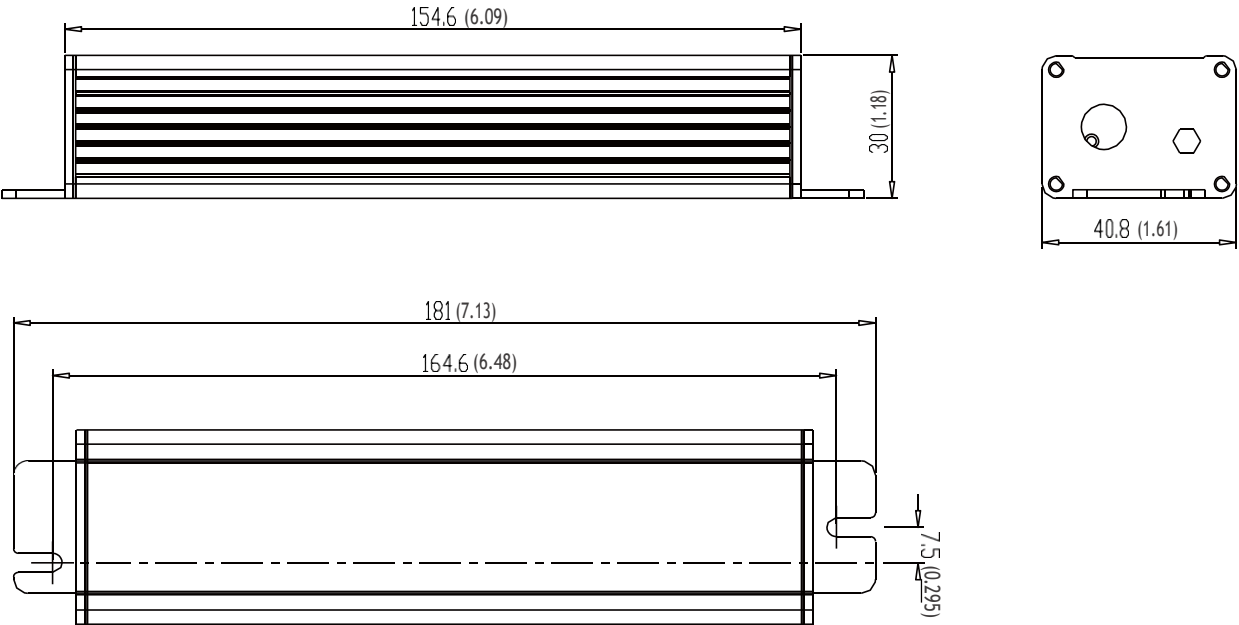

Wiring

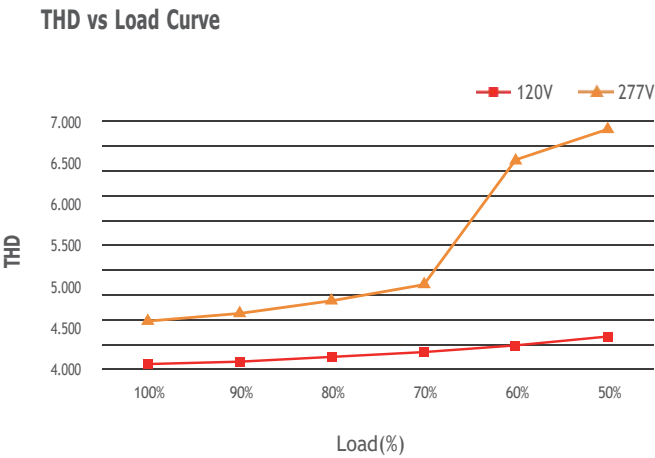
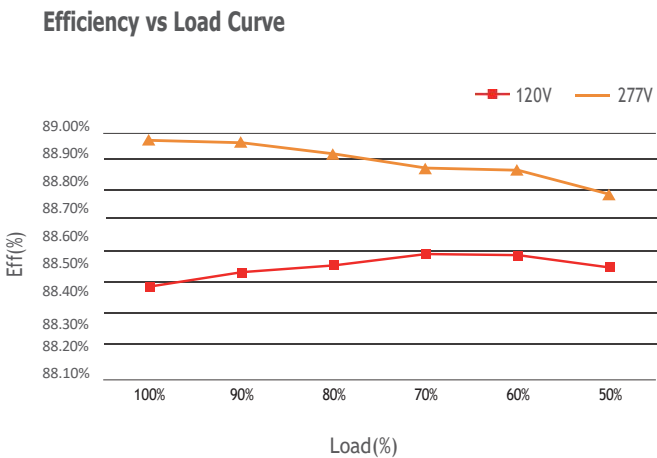
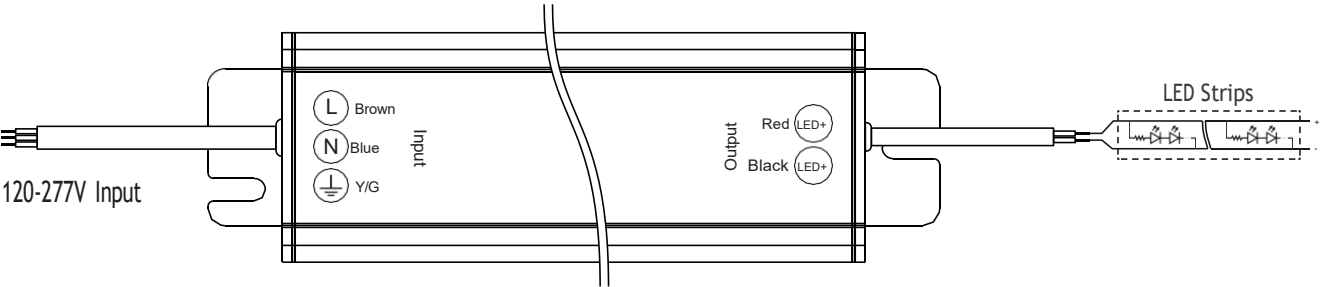

PF vs Load Curve

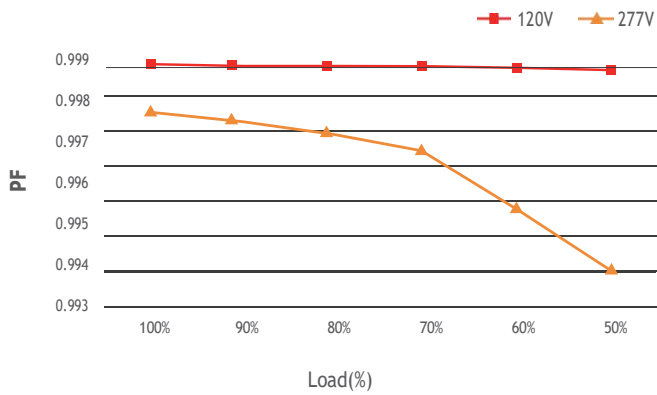

Derating Curve

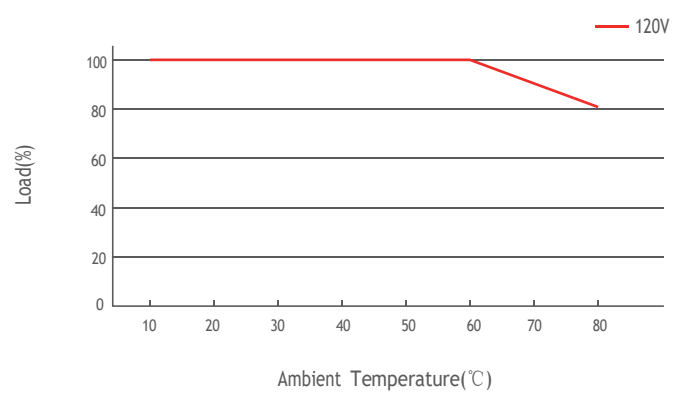

Life-time vs. case temperature

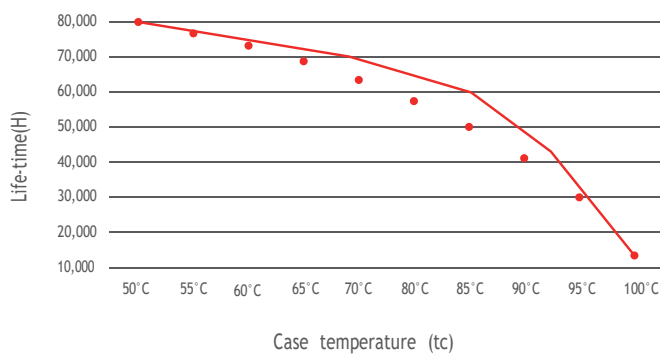

## Max. quantity of drivers per miniature circuit breaker

Specification item	Value	Value	Condition
Inrush current $I_{peak}$	18.5A (120V)	48A (277V)	Input Voltage 120V/277V
Inrush current $T_{width}$	200us (120V)	210us (277V)	Input Voltage 120V/277V, measured at 50% $I_{peak}$

MCB	Input Voltage 120V Drivers	Input Voltage 277V Drivers	MCB	Input Voltage 120V Drivers	Input Voltage 277V Drivers
B10	13pcs	8pcs	C10	13pcs	13pcs
B13	18pcs	10pcs	C13	18pcs	17pcs
B16	22pcs	12pcs	C16	22pcs	21pcs
B20	27pcs	16pcs	C20	27pcs	26pcs
			D16	22pcs	43pcs

## Installation Precautions

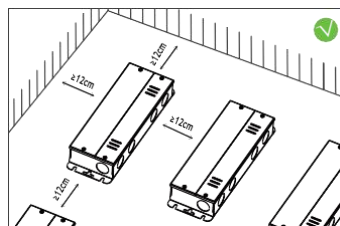
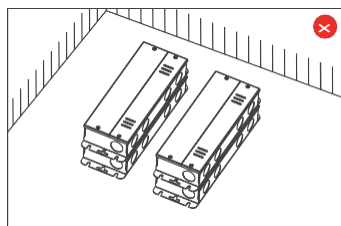
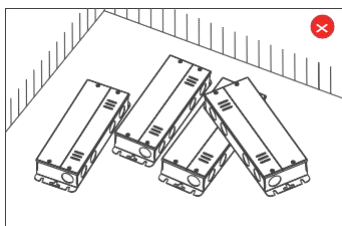

Please do not stack the products. The distance between two products should be >12cm so as not to affect heat dissipation and the lifespan of the products.

## Cautions

This product must be installed and adjusted by a qualified professional.		
1	Confirmation of installation conditions	<ul style="list-style-type: none"><li>· <b>Waterproof and Protection:</b> Install in a suitable location according to the waterproof and protection requirements of the power supply. Products without waterproof function should be protected from direct sunlight and rain. When installing outdoors, please use a waterproof box for protection.</li><li>· <b>Heat dissipation requirements:</b> The drive power supply should avoid exposure to high temperature environments. Please ensure that the working environment temperature is within the recommended range. To ensure proper heat dissipation of the drive power supply, a well ventilated area should be selected for installation. Good heat dissipation conditions can help extend product lifespan.</li></ul>
2	Power check	<ul style="list-style-type: none"><li>· Before use, check the product parameters and confirm that the output voltage and current of the LED power supply meet the requirements</li></ul>
3	Safe wiring	<ul style="list-style-type: none"><li>· Use cables that meet the specifications to ensure that the cross-section of the wire matches the requirements of the driving power supply. Solid cables typically measuring 0.75-2.5 mm<sup>2</sup>, (Please refer to the silk screen printing or wiring diagram in the instruction manual for specific wire diameter requirements).</li><li>· If the power supply (metal casing) is installed on a grounded lighting component or equipment, the power supply needs to be grounded.</li></ul>
4	Wiring confirmation	<ul style="list-style-type: none"><li>· Before power on debugging, ensure that the wiring is secure and avoid poor contact to prevent unstable current or equipment damage.</li></ul>
5	Repair suggestions	<ul style="list-style-type: none"><li>· If the product malfunctions, please do not repair it without authorization. If you have any questions, please contact the supplier or sales team for assistance.</li></ul>

※ The contents of this manual are updated without prior notice. If the function of the product you are using is inconsistent with the instructions, the function of the product shall prevail. Please contact us if you have any questions .

## Warranty Agreement

1. Warranty periods from the date of delivery : 5 years.
2. Free repair or replacement services for quality problems are provided within warranty periods.

### Warranty exclusions below:

The following situations are not covered by the free warranty or replacement service:

1. Exceeding the warranty period.
2. Damage caused by human factors such as high voltage, overload, and improper operation.
3. The appearance of the product is severely damaged or deformed.
4. Normal wear and tear or aging during regular product use.
5. Damage caused by natural disasters or force majeure factors.
6. The quality inspection label of the product is damaged (QC PASS).
7. No contract or valid invoice proof signed with EUCHIPS has been provided.

※Remedies: Repair or replacement is the only remedy provided by EUCHIPS to the customer, and EUCHIPS shall not be liable for incidental damages arising from repair or replacement, unless within the scope of applicable law.

※Adjustment of Warranty Terms: EUCHIPS reserves the right to modify or adjust the warranty terms, which shall be published in writing.