

MUP96M-4W24VN-BW

Product Features

- 4-channel constant voltage output, with a maximum output current of 1A per channel.
- Supports DMX512 signal.
- The number of output channels is 4.
- NFC-enabled for reading and writing DMX addresses and adjusting output voltage.
- Smooth dimming curve, free from flicker.
- Equipped with output short-circuit protection and overload protection, And overcurrent protection
- 50,000 hours lifespan @tc85 °C (185°F).
- 5-year warranty @tc85 °C (185°F).
- UL Class 2.
- Safety compliance with UL8750 & UL 1310.
- Suitable for Dry , Damp & Wet Locations

Application



LED Strip Light

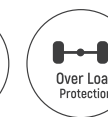

Technical Paramaters

Model	MUP96M-4W24VN-BW	
Input	Efficiency	≥88%@120VAC, full load
	Voltage	120VAC-277VAC
	Frequency Range(Hz)	50/60Hz
	AC Current(max)	1.1Amax @120VAC, 0.6Amax@230VAC, 0.45Amax@277VAC
	PF	≥0.95@120VAC, ≥0.90@277VAC, full load
	THD	<10%@120VAC, <20%@277VAC, full load
	Inrush Current(max)	Cold start,20.30A@120VAC 264us
	Standby power	<2.0W@120VAC
	No load power	<2.0W@120VAC
	Start-up Time	<0.75s, @120Vac (When the light begins to shine)
Output	Current	4 channels, each with 1A
	Voltage	24VDC
	Voltage Range	24-26VDC ±5%(The voltage can be adjusted via NFC)
	Power	96W
	Channel	4
	Ripple Voltage	≤200mV
	PWM Frequency	4KHz PWM
Function	Dimming Type	DMX512/RDM
	Dimming Range	1%-100% (DMX)
	Dimming curve	Logarithm/Linearity (NFC Programming)
	Flicker	Flicker free
Protection	Short Circuit	No output, Auto-Recover when fault removed
	Overload	Hiccup Protection, Auto-Recover when fault removed
	Overcurrent	Hiccup Protection, Auto-Recover when fault removed
Safety&EMC	Surge	L-N:6kV L-N-PG:6kV
	Withstand Voltage	I/P-O/P: 2000Vac/1min/<5mA I/P-PG:1500Vac/1min/<5mA O/P-PG:500Vac/1min/<5mA
	Safety standards	UL8750 UL1310 CSA25013.CSA Class P
	EMC Emission	FCC PART 15 Class B
	EMC Immunity	IEC 61000-4-2-3-4-5-6-8-11
	Insulation Resisance	5M Ω

Others	Working Temp.	-20 °C ~60 °C [-4°F-140°F]
	Storage Temp., Humidity	-40 °C ~85 °C [-40°F-185°F], 20-90%RH
	tc	85 °C (185°F)
	Material	Metal
	IP Rating	IP65
	Lifetime	50,000h@tc:85 °C (185°F)
	Warranty Condition	5 years
	Switch Cycle	25,000 times
	Packing(weight)	Net weight: 930g(2.05 lb)±5%/PCS; 12PCS/Carton; 11.16kg(24.60 lb)±5%/Carton; Carton Size:314*263*249mm(12.36*10.35*9.80 Inch)(L*W*H)
	Dimension	244*106*41.5mm (9.61*4.17*1.63 Inch)(L*W*H)

Dimension Inch (mm)

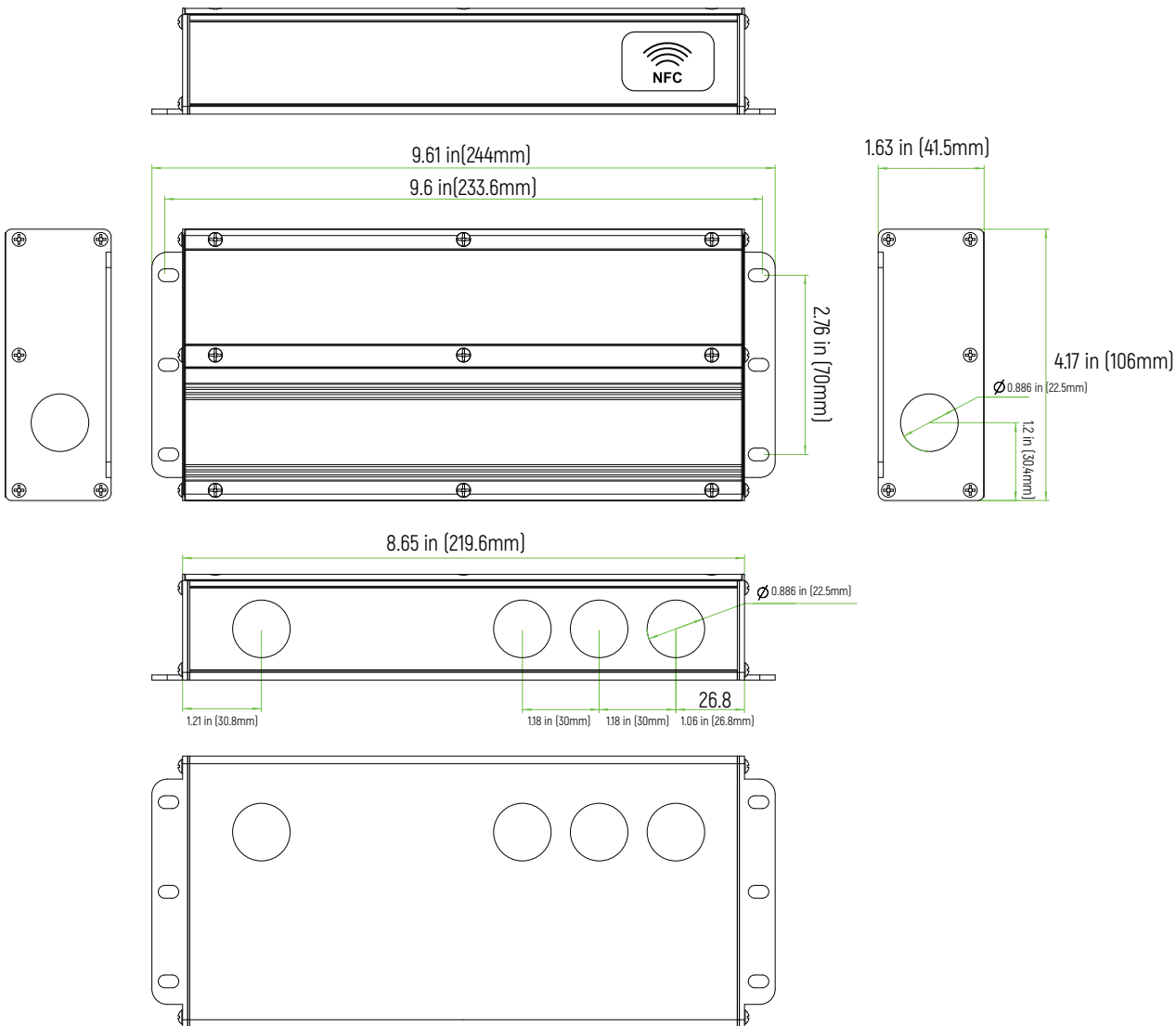

Wiring Diagram

4 channel

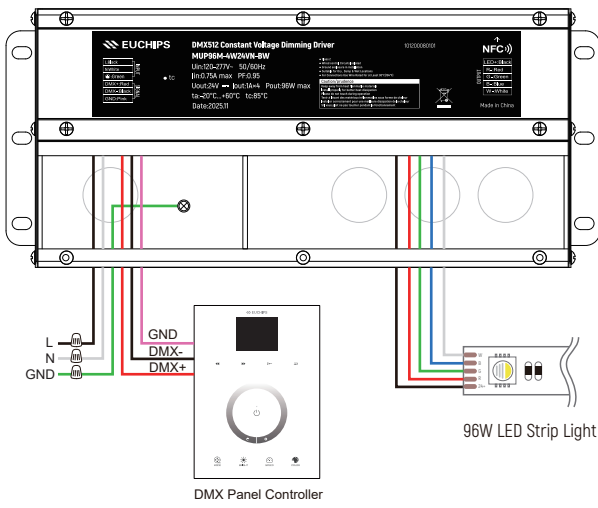

3 channel

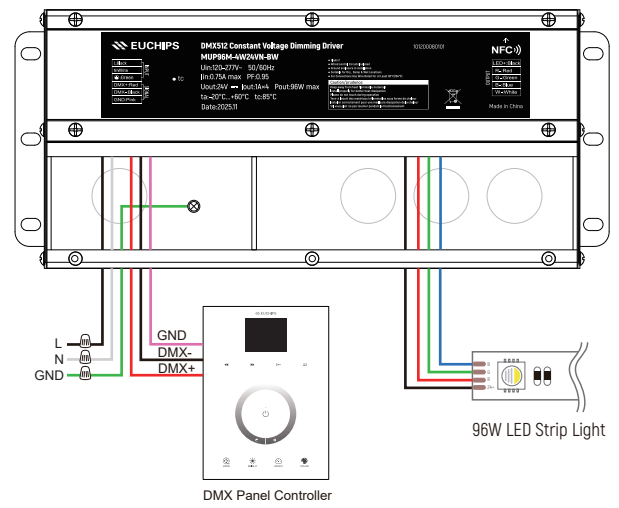

2 channel

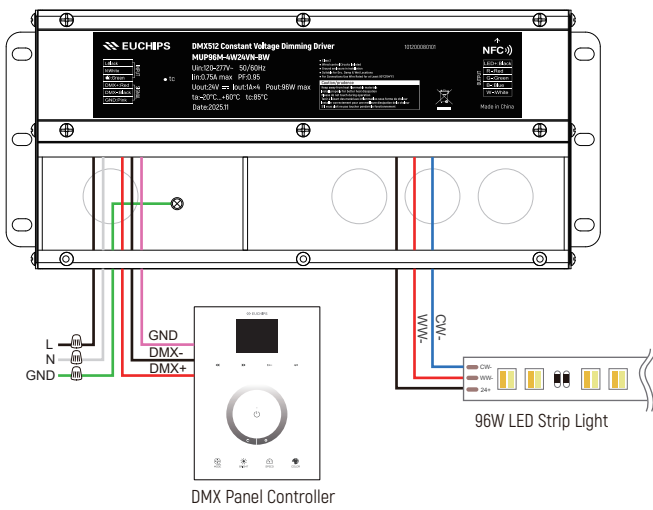

1 channel

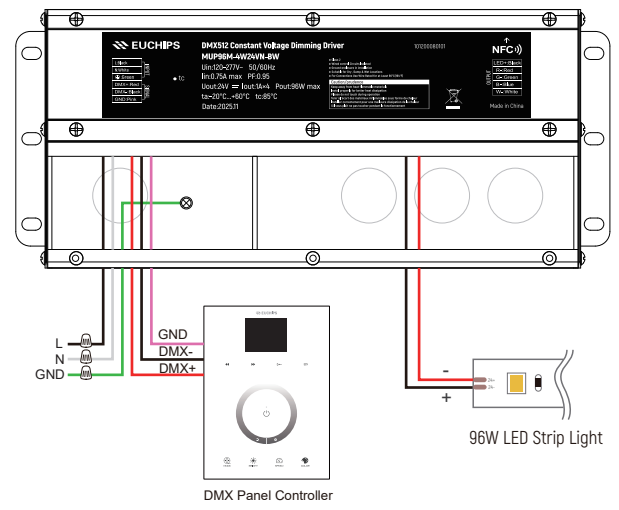

Dimming Curve

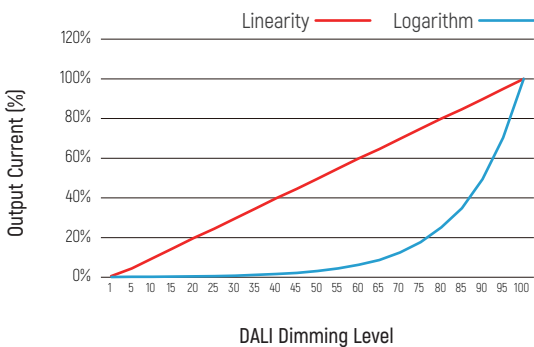

PF vs Load

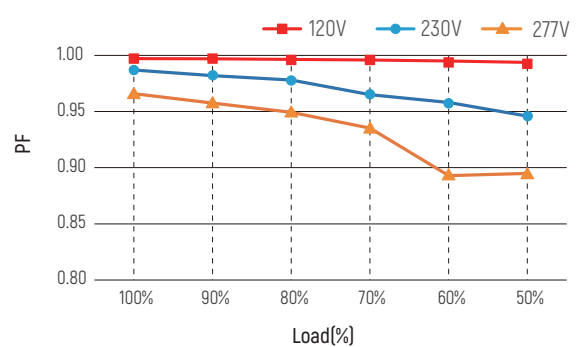

THD vs Load

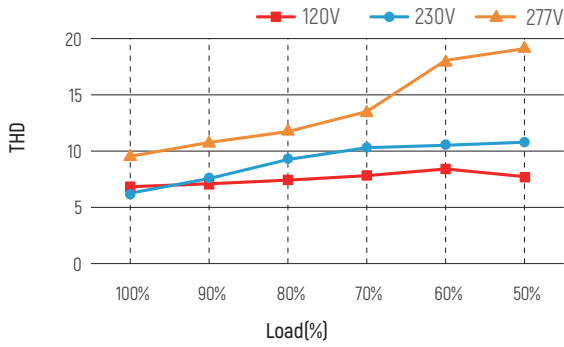

Eff. vs Load

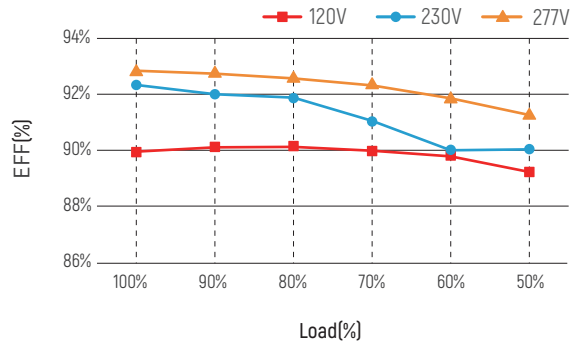

Life-time vs. case temperature

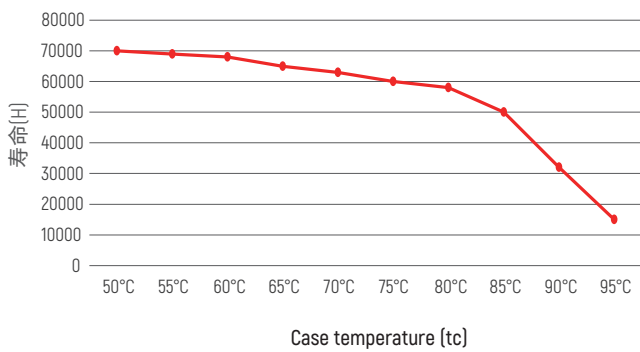

Derating Curve

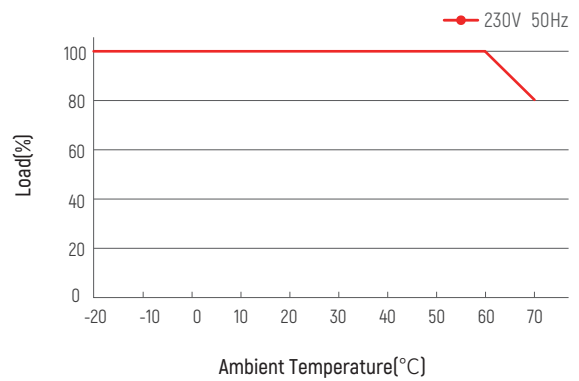

The life-time of the led driver is shown in the figure above (calculated based on the 90% survival rate).

The relation of tc to ta temperature depends also on the luminaire design.

Installation Precautions

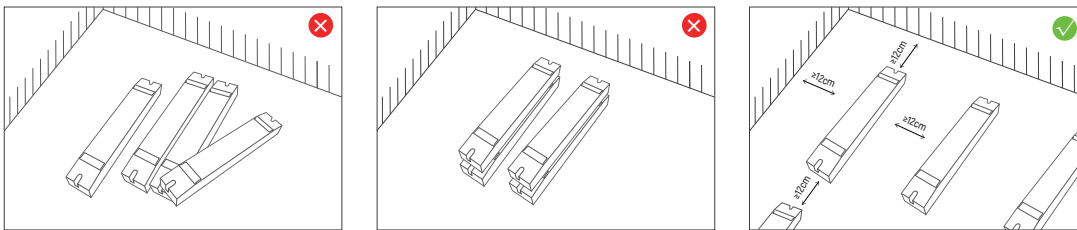

Please do not stack the products. The distance between two products should be >12cm so as not to affect heat dissipation and the lifespan of the products.

Max. quantity of drivers per miniature circuit breaker

Specification item	Value	Condition
Inrush current I_{peak}	20.30A	Input Voltage 120VAC
Inrush current T_{width}	264us	Input Voltage 120VAC, measured to 50% I_{peak}

MCB	Input Voltage 120V Drivers	MCB	Input Voltage 120V Drivers
B10	13pcs	C10	13pcs
B13	17pcs	C13	17pcs
B16	21pcs	C16	21pcs
B20	26pcs	C20	26pcs
		D16	21pcs

Cautions

This product must be installed and adjusted by a qualified professional.		
1	Confirmation of installation conditions	<ul style="list-style-type: none"> · Waterproof and Protection: Install in a suitable location according to the waterproof and protection requirements of the power supply. Products without waterproof function should be protected from direct sunlight and rain. When installing outdoors, please use a waterproof box for protection. · Heat dissipation requirements: The drive power supply should avoid exposure to high temperature environments. Please ensure that the working environment temperature is within the recommended range. To ensure proper heat dissipation of the drive power supply, a well ventilated area should be selected for installation. Good heat dissipation conditions can help extend product lifespan.
2	Power check	<ul style="list-style-type: none"> · Before use, check the product parameters and confirm that the output voltage and current of the LED power supply meet the requirements
3	Safe wiring	<ul style="list-style-type: none"> · Use cables that meet the specifications to ensure that the cross-section of the wire matches the requirements of the driving power supply. Solid cables typically measuring 0.75-2.5 mm², (Please refer to the silk screen printing or wiring diagram in the instruction manual for specific wire diameter requirements). · If the power supply (metal casing) is installed on a grounded lighting component or equipment, the power supply needs to be grounded.
4	Wiring confirmation	<ul style="list-style-type: none"> · Before power on debugging, ensure that the wiring is secure and avoid poor contact to prevent unstable current or equipment damage.
5	Repair suggestions	<ul style="list-style-type: none"> · If the product malfunctions, please do not repair it without authorization. If you have any questions, please contact the supplier or sales team for assistance.

※ The contents of this manual are updated without prior notice. If the function of the product you are using is inconsistent with the instructions, the function of the product shall prevail. Please contact us if you have any questions .

Warranty Agreement

1. Warranty periods from the date of delivery : 5 years.
2. Free repair or replacement services for quality problems are provided within warranty periods.

Warranty exclusions below:

The following situations are not covered by the free warranty or replacement service:

1. Exceeding the warranty period.
2. Damage caused by human factors such as high voltage, overload, and improper operation.
3. The appearance of the product is severely damaged or deformed.
4. Normal wear and tear or aging during regular product use.
5. Damage caused by natural disasters or force majeure factors.
6. The quality inspection label of the product is damaged (QC PASS).
7. No contract or valid invoice proof signed with EUCHIPS has been provided.

※ Remedies: Repair or replacement is the only remedy provided by EUCHIPS to the customer, and EUCHIPS shall not be liable for incidental damages arising from repair or replacement, unless within the scope of applicable law.

※ Adjustment of Warranty Terms: EUCHIPS reserves the right to modify or adjust the warranty terms, which shall be published in writing.